

Eureka Economy Terminals

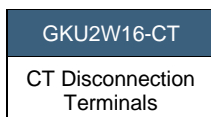

Eureka ATB Terminal, Earth Terminals, Terminal End Clamps

- Rated Voltage: 600VAC
- Rated Current: 20-164 A
- Terminal end Caps to suit ATB terminals
- Range of Accessories available.

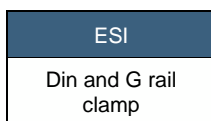
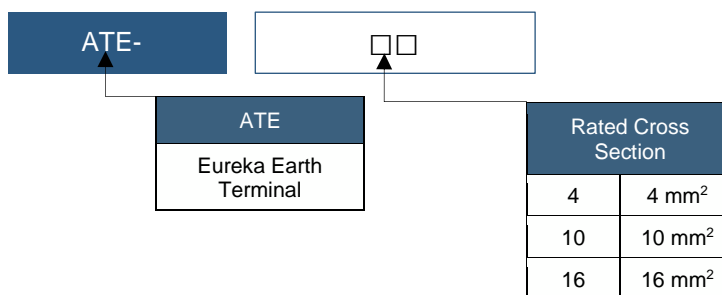
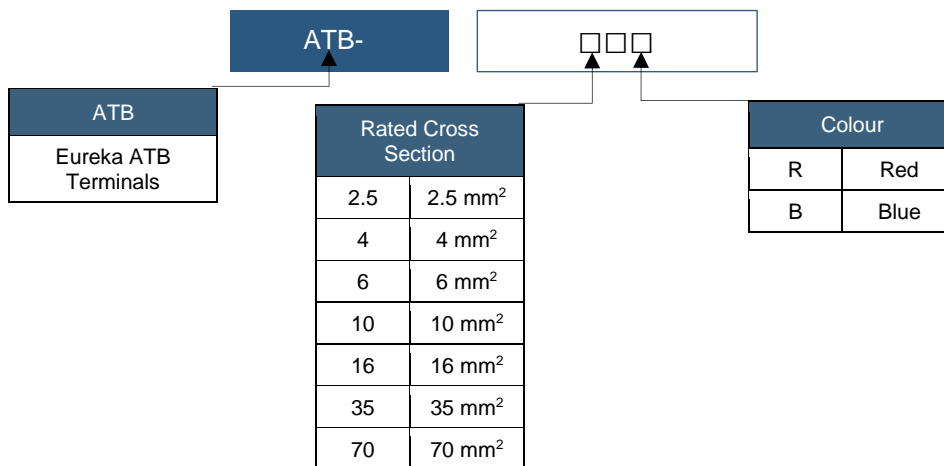

Properties

Properties	
Manufacturer	Eureka
Product Range	Eureka Economy Terminals
Terminal Types	ATB- Terminals ATE- Earth Terminals ESI- End Stop GKU2W16-CT- CT Disconnection Terminal
Rated Voltage	600VAC
Rated Current	20-165A
Pitch	5-24mm
Standards Compliance	TUV, CSA

Accessories

AT-JB-2.5-70	70 way Jumper bar 2.5mm terminal
AT-JB-2.5-10	10 way Jumper bar 2.5mm terminal
AT-JB-4.0-10	10 way Jumper bar 4.0mm terminal
AB1-G-(letter)	Terminal (250)
AB1-R-(number)	Terminal (250)

ATB- Terminal Ratings and Dimensions

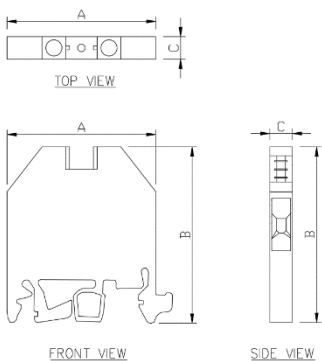

Part No.	Terminal End Cap Part No.	Rated Current/A	A	B	C
ATB-2.5	EC4	20	39.7	47.0	5.0
ATB-4	EC4	30	39.7	47.0	6.0
ATB-6	EC6	40	46.8	52.2	8.0
ATB-10	EC10	60	54.0	63.6	9.6
ATB-16	EC16	75	66.0	67.6	12.3
ATB-35	EC35	100	75.0	80.6	16.0
ATB-70	-	165	76.5	86.0	24.0

**NOTE: ATB-70 is double sided protected (does not require end cap)

ATE- Earthing Terminal Ratings and Dimensions

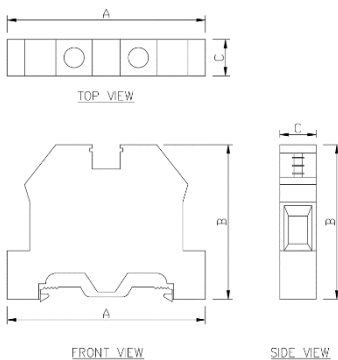

Part No.	Rated Surge Voltage/ KV	A	B	C
ATE-4	8	56.0	41.0	8.5
ATE-10	8	57.0	44.5	10.5
ATE-16	12	50.8	51.5	12.5

Catalogue number: **ATB-□□, ATE-□□, ESI,
GKU2W16-CT**

Eureka Economy Terminals



ESI

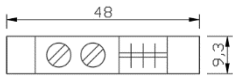

TOP VIEW

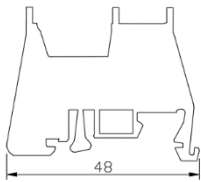

FRONT VIEW

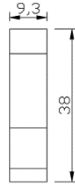

SIDE VIEW

GKU2W16-CT

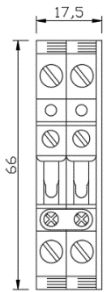

TOP VIEW

